

Kurling for Kids 2013

Giraffe for the Neonatal Intensive Care Unit (\$60,000)

The "Giraffe" is a state-of-art incubator combined with a radiant warmer. In a high humidity environment, this equipment provides superior care to premature newborns that have a very low birth weight.

Over the years, the Foundation has been able to equip the NICU with "Giraffes", but more are needed to continue to improve the level of care for our youngest and most fragile patients.



YEAR 2 OF THE NAMING OPPORTUNITY AT THE NEW CHILDREN'S HOSPITAL (\$300,000 PLEDGED OVER 5 YEARS)

"Kurling for Kids" Playroom on the Medical/Surgical Ward - Location: 8th Floor, Pavillion B, Size: 14.29 m² (154 ft²)



Plan of 8th floor medical/surgical unit showing location of playroom

The medical/surgical pediatric patient care units will provide high-quality care to general medical and surgical patients who require admission to the hospital. The age group that will be admitted includes those from infant through age 18. This floor will accommodate hospitalized patients, as well as patients admitted to the short stay unit directly from the Emergency Department. All 34 patient rooms will be single, with private washrooms and place for a parent to spend the night. The projected occupancy rate on the wards is about 85%.

As this unit will be running on a 24-hour basis, the child life specialists will have the opportunity to organize a multitude of activities for the patients, including arts & crafts, movie nights and readings, all of which will cater to various age groups. This enclosed, dedicated space will be equipped with toys, books, computer workstations, a sink and adjacent space for storage.

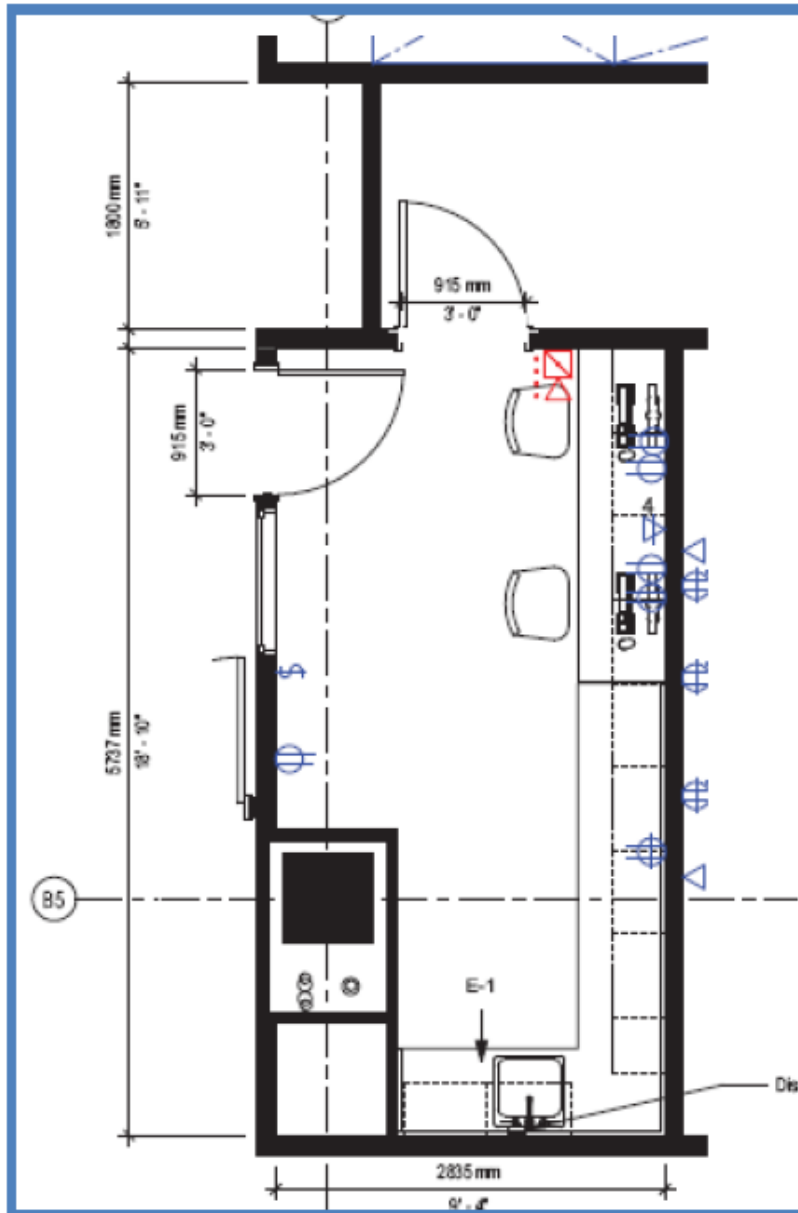

Layout of the Kurling for Kids play room